

GENERAL NOTES:

WORK HEALTH AND SAFETY
THE CONTRACTOR SHALL FAMILIARISE THEMSELVES WITH, AND WORK IN ACCORDANCE TO, THE WORK HEALTH AND SAFETY ACT 2011 AND THE WORK HEALTH AND SAFETY REGULATION 2011. THE CONTRACTOR SHALL ENSURE THAT ALL EMPLOYEES CARRYING OUT CONSTRUCTION WORK UNDERTAKE SPECIFIC (GENERAL, WORK ACTIVITY AND SITE SPECIFIC) WORK HEALTH AND SAFETY INDUCTION TRAINING RELATED TO THE WORKS THEY ARE PERFORMING.

STANDARDS
ALL PLANTING WORKS SHALL COMPLY WITH THE CURRENT EDITION OF RELEVANT AUSTRALIAN STANDARDS INCLUDING:
· 1997: AS4454 COMPOSTS, SOIL CONDITIONERS AND MULCH
· 1998: AS4419 SOIL FOR LANDSCAPING AND GARDEN USE
GRADING
THE LANDSCAPE CONTRACTOR SHALL GRADE SURFACE AREAS TO AN ACCEPTABLE SLOPE BATTER (MAX 1 IN 3) AND AWAY FROM BUILT AREAS WHERE POSSIBLE.

PLANT QUALITY
THE CONTRACTOR SHALL REMAIN RESPONSIBLE FOR THE PLANTS TO CORRECT NURSERY CONDITONS (INCLUDING THE HARDENING OFF PERIOD) TO TIME OF PLANTING. PROVIDE PLANTS WITH THE FOLLOWING CHARACTERISTICS:
· LARGE HEALTHY ROOT SYSTEMS, WITH NO EVIDENCE OF ROOT CURL, RESTRICTION OR DAMAGE
· VIGOROUS, WELL ESTABLISHED, FREE FROM DISEASES OR INSECT PESTS, OF GOOD FORM CONSISTENT WITH SPECIES OR VARIETY
· HARDENED OFF, NOT SOFT OR FORCED, AND SUITABLE FOR PLANTING IN THE NATURAL CLIMATIC CONDITIONS PREVAILING AT THE SITE
· HAVE FOLIAGE SIZE, TEXTURE AND COLOUR CONSISTENT WITH THAT SHOWN IN HEALTHY SPECIMENS OF THE SPECIES.

· IMMEDIATELY REJECT DRIED OUT, DAMAGED, POT BOUND OR UNHEALTHY PLANT MATERIAL BEFORE PLANTING. MAKE NO SUBSTITUTIONS. SHOULD PLANT MATERIAL SPECIFIED BE UNAVAILABLE THEN THE CONTRACTOR SHALL INFORM THE LANDSCAPE ARCHITECT IN WRITING WITH AVAILABLE SUBSTITUTIONS FOR APPROVAL.

PLANT MATERIALS REQUIREMENTS
SUPPLY PLANTS IN WEED FREE CONTAINERS OF THE REQUIRED SIZE. PLANT SIZE DEFINITIONS ARE INDICATED ONLY AND ARE SUBJECT TO VARIATION IN ACCORDANCE WITH THE NATURAL GROWTH HABIT OF THE SPECIES.

REPLACEMENTS
USING PLANTS OF THE SAME TYPE, QUALITY AND SIZE, THE CONTRACTOR SHALL REPLACE ANY PLANTS WHICH ARE DAMAGED WHILST BEING TRANSPORTED TO THE SITE OR DURING THE WORKS, OR WHICH FAIL OR ARE REJECTED AT THE CONTRACTORS EXPENSE.

STORAGE
DELIVERY PLANT MATERIAL TO THE SITE ON A DAY-TO-DAY BASIS AND PLANT IMMEDIATELY AFTER DELIVERY. IF THIS IS NOT POSSIBLE, KEEP THE PLANTS IN A GOOD CONDITION ON THE SITE, ADEQUATELY PROTECTED FROM FROST, WIND, SUN AND VERMIN BY APPROPRIATE STORAGE METHODS. DO NOT STORE PLANTS ON SITE WITHOUT APPROVAL FROM THE LANDSCAPE ARCHITECT.

WATERING
WATER IMMEDIATELY AFTER PLANTING. RAISE THE SOIL MOISTURE WITHIN THE ROOTBALL TO FIELD CAPACITY. ENSURE ROOTBALL IS THOROUGHLY WETTED THROUGH TO ENTIRE SOIL PROFILE. CONTINUE WATERING AT A RATE AND FREQUENCY REQUIRED TO AVOID WATER STRESS.

PLANTINGS
ANY RUBBLE REMAINING WITHIN THE LANDSCAPE AREAS AT THE TIME OF PLANTING SHALL BE REMOVED BY HAND. EXCAVATE THE PLANTING HOLE TO DEPTHS AS PER THE DETAILS. LOOSEN THE COMPACTED SIDES OF THE HOLE TO PREVENT CONFINEMENT OF ROOT GROWTH.

PLACING
REMOVE THE PLANT FROM THE CONTAINER WITH MINIMUM DISTURBANCE TO THE ROOT BALL. ENSURE THAT THE ROOT BALL IS MOIST AND PLACE IT IN ITS FINAL POSITION, IN THE CENTRES OF THE HOLE AND PLUMB, AND WITH THE TOP SOIL LEVEL OF THE PLANT ROOT BALL LEVEL WITH THE FINISHED SURFACE IF THE SURROUNDING SOIL. TREES TO BE PLANTED WHERE NOTED, SHRUBS TO BE PLANTED AT 1000MM CENTRES WHERE NOTED, GROUND COVERS AT 600MM.

INSECT AND DISEASE CONTROL
IMMEDIATELY GIVE NOTICE OF EVIDENCE OF INSECT ATTACK OR DISEASE AMONGST PLANT MATERIAL. WHERE REQUIRED, SPRAY WITH INSECTICIDE, FUNGICIDE OR BOTH WITH THE MANUFACTURER'S RECOMMENDATION. SUBMIT PROPOSAL AND OBTAIN APPROVAL FROM LANDSCAPE ARCHITECT BEFORE STARTING THIS WORK.

MULCH
MULCH SHALL BE NATURAL COLOUR FOREST FINES. MULCH SHALL BE PROVIDED TO EACH PLANTING BED TO A DEPTH OF 90MM AND PLACED TO PREVENT CONTACT WITH THE TREE TRUNK/PLANT STEM. MULCH SHALL FINISH FLUSH WITH ADJACENT SURFACES. MULCH SHALL BE CLEAN AND FREE OF ANY DELETERIOUS MATERIALS.

IMPORTED SOILS
IF REQUIRED, IMPORTED SOIL SHALL BE AN ORGANIC SOIL MIX WITH A SANDY LOAM TEXTURE. EXCAVATED AREAS SHALL BE PREPARED, TRIMMED AND FINISHED PRIOR TO PLACEMENT OF IMPORTED SOIL. SOIL COMPONENTS MUST REMAIN IN A THOROUGHLY BLENDED COMPOSITION AND BE KEPT MOIST DURING BACKFILLING AND LIGHT COMPACTION TO PREVENT

NOTE:

NO TREES OR ROCKS OUTCROPS ON SITE TO BE RETAINED - OBJECTIVE 2.3C-2
AT LEAST 50% OF PLANTS ARE SPECIES NATIVE TO REGION - OBJECTIVE 2.3C-3

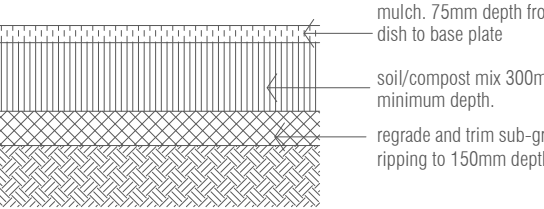

garden mulch bed detail nts

COPYRIGHT 2022 PROPECTUS DESIGN

REPRODUCTION OF THE WHOLE OR PART OF THE DOCUMENT CONSTITUTES AND INFRINGES COPYRIGHT. THE INFORMATION, IDEAS AND CONCEPTS CONTAINED IN THIS DOCUMENT IS / ARE CONFIDENTIAL. THE RECIPIENT(S) OF THIS DOCUMENT IS / ARE PROHIBITED FROM DISCLOSING SUCH INFORMATION IDEAS AND CONCEPTS TO ANY PERSON WITHOUT PRIOR WRITTEN CONSENT OF THE COPYRIGHT HOLDER.
BUILDER / CONSULTANTS TO CHECK AND VERIFY ALL LEVELS, DATUMS & DIMENSIONS ON SITE AND SHALL REPORT ANY DISCREPANCIES OR OMISSIONS TO THIS OFFICE PRIOR TO START OF WORK & DURING THE CONSTRUCTION PHASE.
THIS DRAWING IS TO BE READ AND UNDERSTOOD IN CONJUNCTION WITH STRUCTURAL, MECHANICAL, ELECTRICAL AND OR ANY OTHER CONSULTANT/S DOCUMENTATION AS MAY BE APPLICABLE TO THE PROJECT PRIOR TO START OF WORK & ITS DURATION.
MEASUREMENT SCALING OF THIS DRAWING SHALL ONLY BE PERMITTED IN ITS DIGITAL FORM.
DIAL 1100 BEFORE YOU DIG PRIOR TO ANY EARTH EXCAVATION.

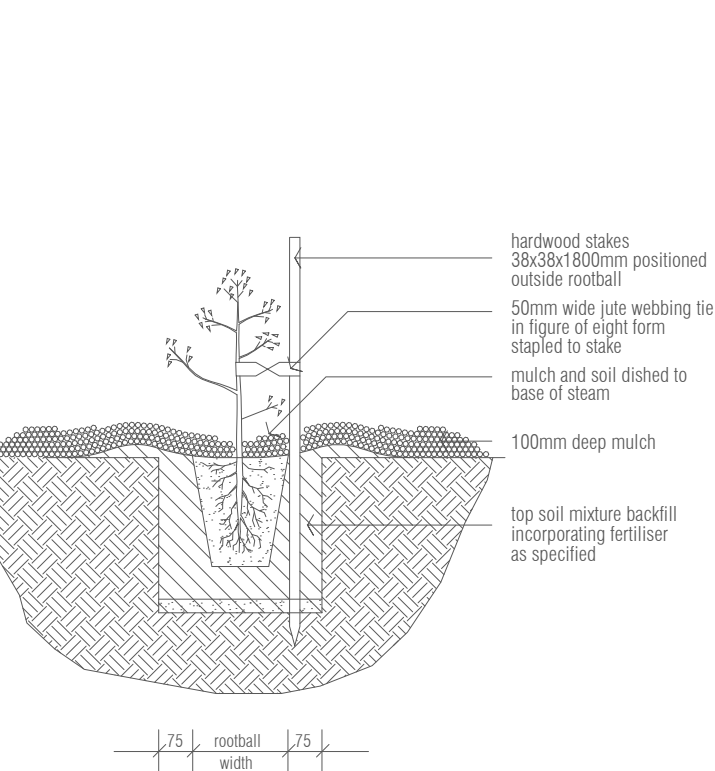
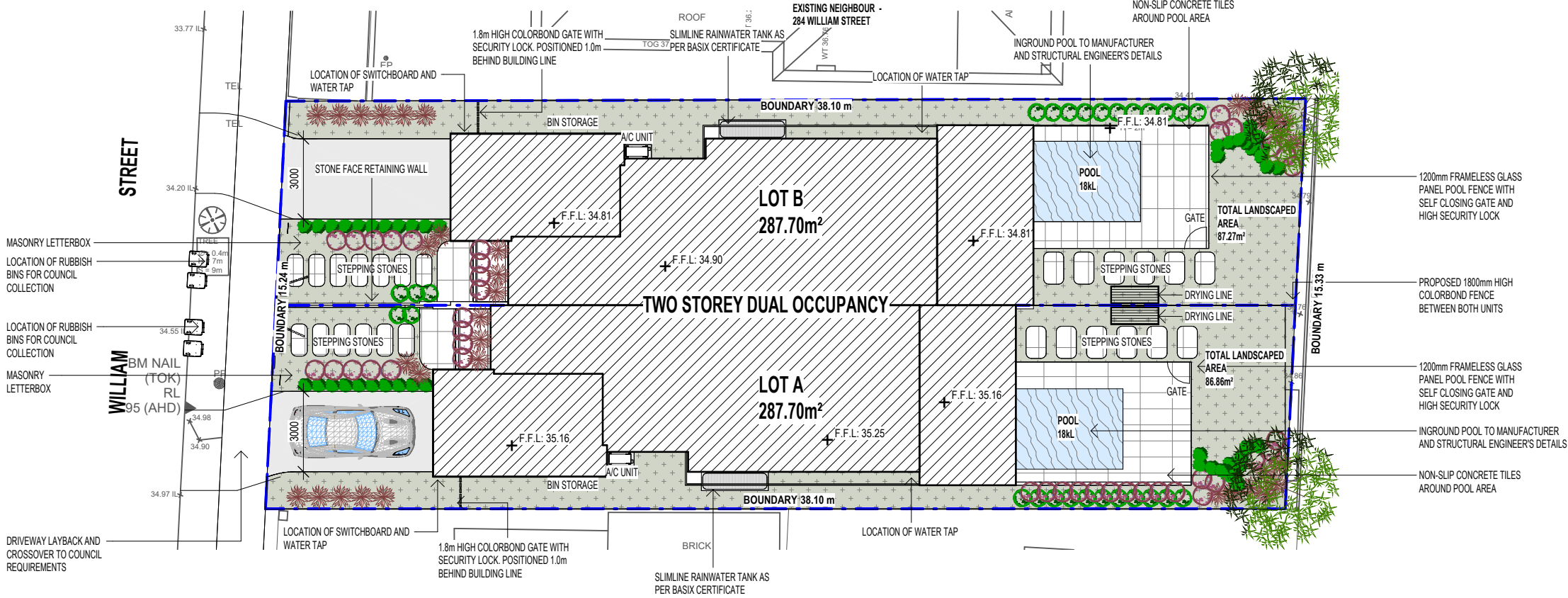

planting detail (advanced tree) nts

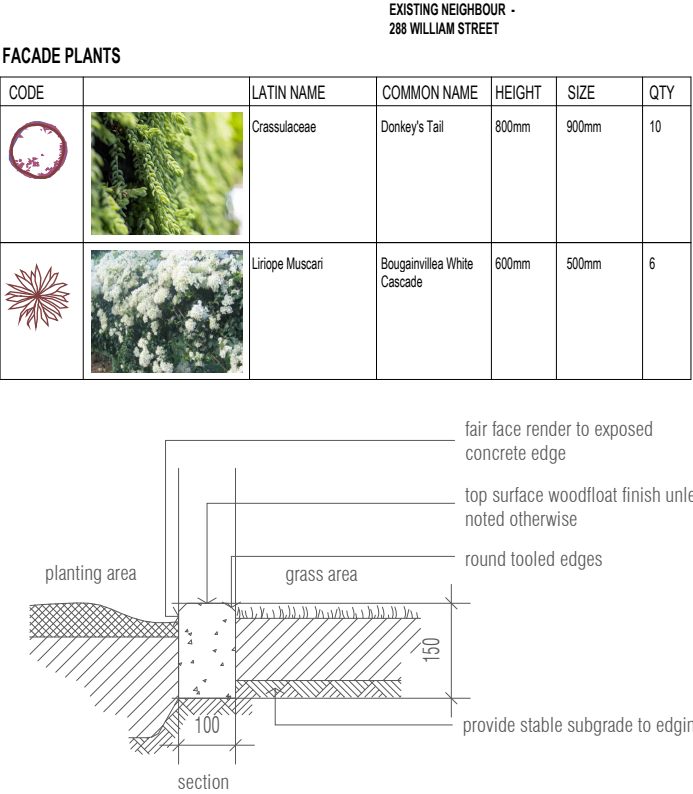

concrete garden edge detail. nts

FACADE PLANTS						
CODE		LATIN NAME	COMMON NAME	HEIGHT	SIZE	QTY
		Crassulaceae	Donkey's Tail	800mm	900mm	10
		Liriope Muscari	Bougainvillea White Cascade	600mm	500mm	6

PLANT SCHEDULE

TREES

CODE		LATIN NAME	COMMON NAME	HEIGHT	SIZE	SPREAD	QTY
		Jacaranda Mimosifolia	Jacaranda	8m	25L	5m	2

SHRUBS

CODE		LATIN NAME	COMMON NAME	HEIGHT	SIZE	QTY
		Nandina Domestica	Dwarf Nandina	600mm	600mm	47
		Syzygium Australe	Pinnacle	2m	1 - 1.5m	27

GROUND COVERS

CODE		LATIN NAME	COMMON NAME	HEIGHT	SIZE	QTY
		Alternanthera Dentata	Little Ruby	800mm	900mm	42
		Liriope Muscari	Just Right	500mm	500mm	29

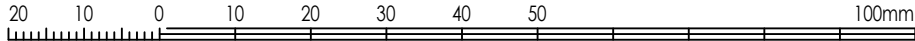

DUPLEX

CLIENT: MR JIM PETRATOS
286 WILLIAM STREET
KINGSGROVE NSW 2208
LOT 68 DP 22360

PROPOSED LANDSCAPE PLAN

JOB # 020322
DATE: 15.07.22
DA ISSUE

DRAWN: SP
CHECKED: SP
SCALE: As indicated

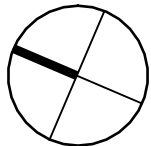

ISSUE: D

DWG NO.

A0006